

SYSTEM D-GROOVING

Einstecken mit ein- oder zweischneidigen Schneideinsätzen

grooving with one- or two-cutting edges inserts

Typ DZ24.M1

Schneideinsatz lang, zweischneidig, Spanformer M1

insert long, two-cutting edges, chipbreaker M1

Stechbreite b
2.0 / 3.0 / 4.0 / 5.0 / 6.0 mm

width of groove b
2.0 / 3.0 / 4.0 / 5.0 / 6.0 mm

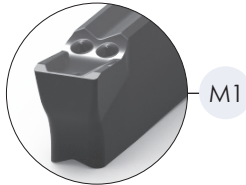

M1

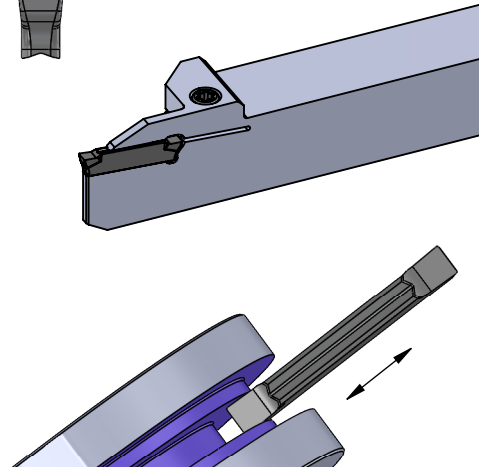
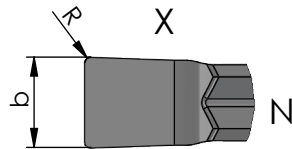
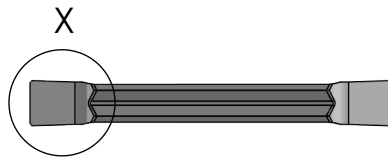

Beispielzeichnung
exemplary application

Ausrichtung Schneide
alignment cutting edge

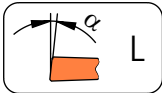
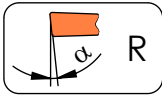

Neutral (N): wie gezeichnet

Neutral (N): as shown

Abmessungen in mm

dimensions in mm

Bestellnummer part number	b	R	L	H	α	Ausrichtung Schneide alignment cutting edge					Klemhalter Typ toolholder type	Klinge Typ blade type
							P04C	VC10	VP12	K06P		
neu DZ24.R2015.M1	2.0	0.15	24	5.15	6°	R	●	●	●			
neu DZ24.L2015.M1	2.0	0.15	24	5.15	6°	L	●	●	●			
neu DZ24.N2020.M1	2.0	0.20	24	5.15	0°	N	●	●	●			
neu DZ24.R3020.M1	3.0	0.20	24	5.15	6°	R	●	●	●			
neu DZ24.L3020.M1	3.0	0.20	24	5.15	6°	L	●	●	●			
neu DZ24.N3020.M1	3.0	0.20	24	5.15	0°	N	●	●	●			
neu DZ24.R4030.M1	4.0	0.30	24	5.15	4°	R	●	●	●	DHR. ... DHL. ...	DKR.D24 DKL.D24 DKN.D24	
neu DZ24.L4030.M1	4.0	0.30	24	5.15	4°	L	●	●	●			
neu DZ24.N4030.M1	4.0	0.30	24	5.15	0°	N	●	●	●			
neu DZ24.N5040.M1	5.0	0.40	24	5.15	0°	N	●	●	●			
neu DZ24.N6040.M1	6.0	0.40	24	5.15	0°	N	●	●	●			



Bestellbeispiel:
für Sorte P04C:
DZ24.R2015.M1/P04C

order-example:
grade P04C:
DZ24.R2015.M1/P04C