

## SYSTEM D-GROOVING

Einstecken mit ein- oder zweischneidigen Schneideinsätzen

grooving with one- or two-cutting edges inserts

## Typ DZ24. ... .F1

Schneideinsatz lang, zweischneidig, Spanformer F1

insert long, two-cutting edges, chipbreaker F1

Stechbreite b  
2.0 / 3.0 / 4.0 / 5.0 mm

width of groove b  
2.0 / 3.0 / 4.0 / 5.0 mm

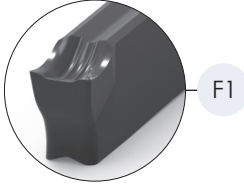

F1

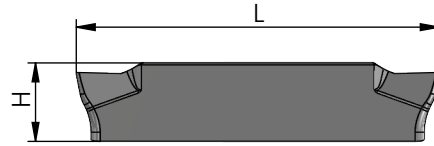

X

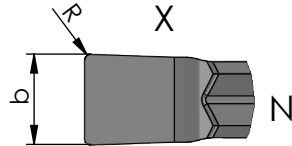
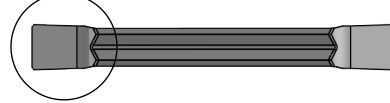

Beispielzeichnung  
exemplary application

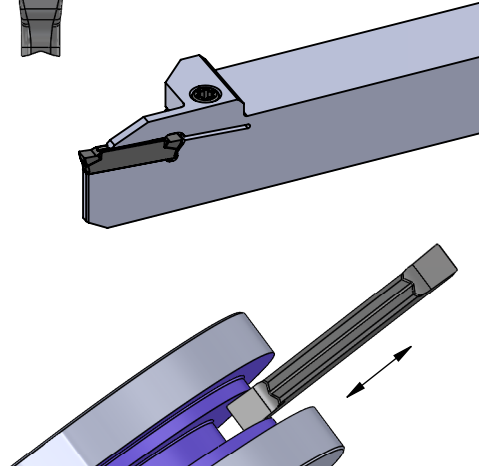

Ausrichtung Schneide  
alignment cutting edge



R

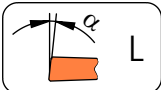

L

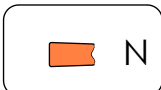

N

Neutral (N): wie gezeichnet

Neutral (N): as shown

Abmessungen in mm

dimensions in mm

Bestellnummer part number	b	R	L	H	α	Ausrichtung Schneide alignment cutting edge					Klemhalter Typ toolholder type	Klinge Typ blade type
							P04C	VC10	VP12	K06P		
<b>neu</b> DZ24.R2015.F1	2.0	0.15	24	5.15	6°	R	●	●	●			
<b>neu</b> DZ24.L2015.F1	2.0	0.15	24	5.15	6°	L	●	●	●			
<b>neu</b> DZ24.N2020.F1	2.0	0.20	24	5.15	0°	N	●	●	●			
<b>neu</b> DZ24.R3020.F1	3.0	0.20	24	5.15	6°	R	●	●	●			
<b>neu</b> DZ24.L3020.F1	3.0	0.20	24	5.15	6°	L	●	●	●			
<b>neu</b> DZ24.N3020.F1	3.0	0.20	24	5.15	0°	N	●	●	●	DHR. ...	DKR. ... .D24	
<b>neu</b> DZ24.R4030.F1	4.0	0.30	24	5.15	5°	R	●	●	●	DHL. ...	DKL. ... .D24	
<b>neu</b> DZ24.L4030.F1	4.0	0.30	24	5.15	5°	L	●	●	●			
<b>neu</b> DZ24.N4030.F1	4.0	0.30	24	5.15	0°	N	●	●	●			
<b>neu</b> DZ24.N5040.F1	5.0	0.40	24	5.15	0°	N	●	●	●			

Bestellbeispiel:  
für Sorte P04C:  
DZ24.R2015.F1/P04C

order-example:  
grade P04C:  
DZ24.R2015.F1/P04C